

CERTIFIED A TRUE COPY OF THE ORIGINAL IN OUR POSSESSION  
Jonathan Guy, Solicitor  
Anderson Strathern LLP  
1 Rutland Court  
Edinburgh, EH3 8EY

note:  
do not scale from drawings. discrepancies in figured dimensions to be notified to the architect.

rev: description: drawn: chkd: date:  
A NEW LICENSE APPLICATION MT 10/2013

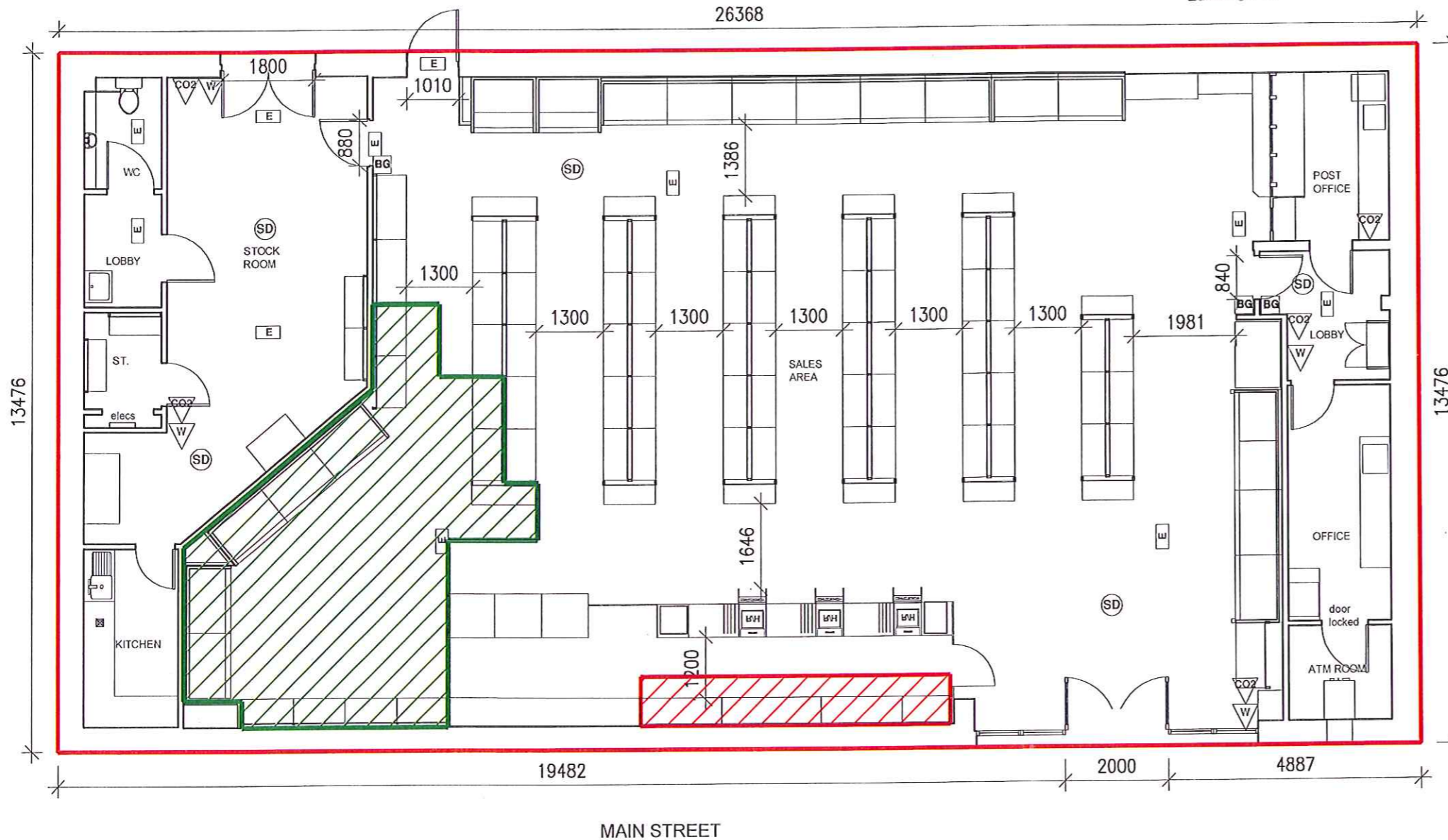

- LEGEND
- (S) FIRE ALARM SOUNDER UNIT
  - (SD) SMOKE DETECTOR
  - (HD) HEAT DETECTOR
  - (E) EMERGENCY LIGHT
  - CO2 CARBON DIOXIDE EXTINGUISHER
  - W WATER EXTINGUISHER
  - BG BREAK GLASS UNIT

Emergency lighting system to comply with British Standard 5266: Part 1: 1999. (Maintained- 2hour duration) and BS EN 1838:1999 (or BS 5266-7: 1999)

Firefighting Equipment to comply with British Standard EN3, British Standard 7863: 1996, British Standard 5306-3: 2000 and British Standard 5306-8: 2000

Signs and notices to comply with the Health and Safety (Safety Signs and Signals) Regulations 1996 and / or British Standard 5499: Part 1: 1990.

## smithfindlay:architects

2 Merkland Street T 0141 334 4995 E design@smithfindlay.co.uk  
Glasgow G11 6DB F 0141 334 8186 W www.smithfindlay.com

project:  
SCOTMID FOODSTORE  
165a MAIN STREET, RENTON  
STORE NO:-343

title:  
LICENSE APPLICATION LAYOUT

scale: drawn: checked: date:  
1:100 GM 04/11

job:	drawing number:	rev:
1338	L(10)1	A

## West Dunbartonshire Licensing Board



THE LICENSING (SCOTLAND) ACT, 2005

PREMISES: Scotmid, 165a Main Street, Renton, Alexandria G82 4PS

This is the layout plan associated with the Premises Licence in respect of the above premises granted by West Dunbartonshire Licensing Board under delegated powers on 24 October 2013.

*E. J. Lynch*

Depute Clerk to the Licensing Board

Areas	
	Secure sales area
Display Frontage -	
Length 6.0m	
Height 2.0m	
Capacity 12.0m <sup>2</sup>	
	Open alcohol sales area
Display Frontage -	
Length 15.0m	
Height 2.4m	
Capacity 36.0m <sup>2</sup>	
Stacked Alcohol Frontage -	
Length 4.0m	
Height 1.5m	
Capacity 6.0m <sup>2</sup>	
Total Capacity = 54m <sup>2</sup>	