

SECTION 1:100 A-A

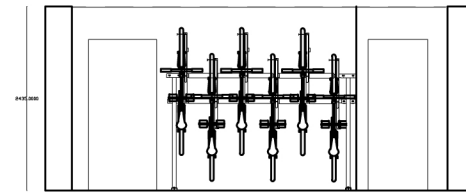

SECTION 1:100 B-B

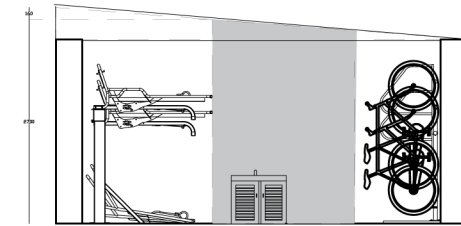

SECTION 1:100 C-C

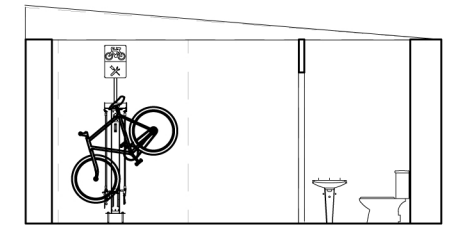

SECTION 1:100 D-D

Building has Double storage for 12 bikes,  
Vertical storage for 6 bikes,  
WC, Bike repair Station or sink area  
Total: 18 bikes

1. Double bike storage requires: 2700 mm height, 1850 mm depth, min 1700 mm front access space
2. Vertical bike storage requires: min 2150 mm height, 1200 mm depth, 1500 mm front access space

### Double bike storage for electrical bicycles (includes charging area)

#### Store a bike in four easy steps

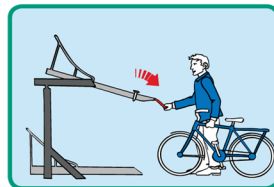

1. Pull handle to lift the rack toward you.

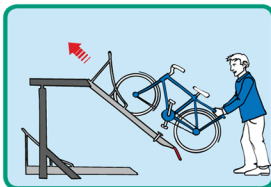

2. Lift front wheel onto the rack and push up.

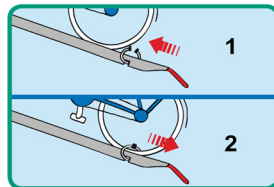

3. The wheel is gripped automatically.

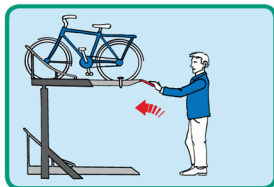

4. Lock the bike and lift the rack back into the upright position.

#### Retrieving a bike in four easy steps

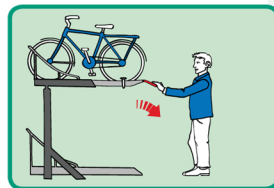

1. Pull handle to lift bike toward you.

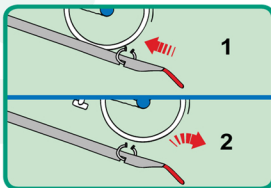

2. Pull the bike forward to release the wheel lock.

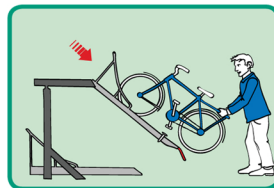

3. Unlock and slide the bike down.

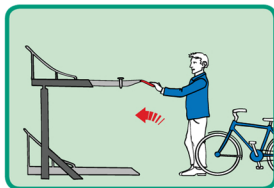

4. Lift the rack back into the upright position.



### Vertical bike storage

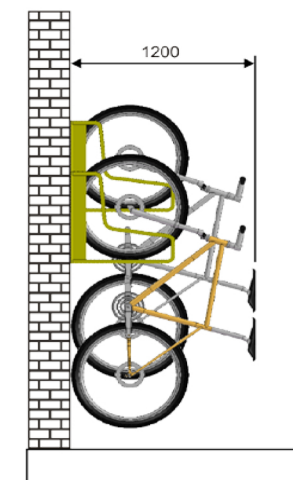
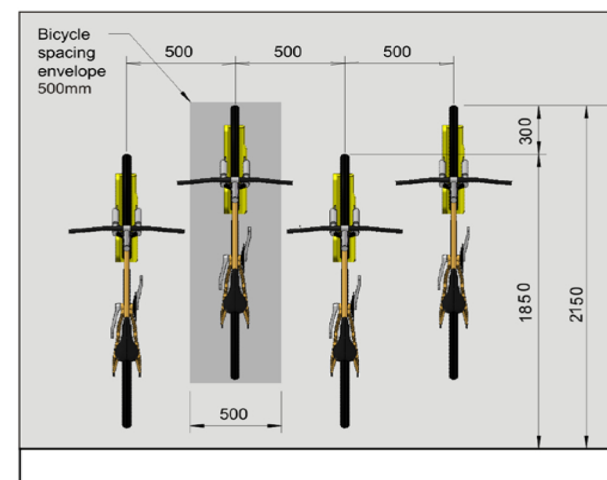
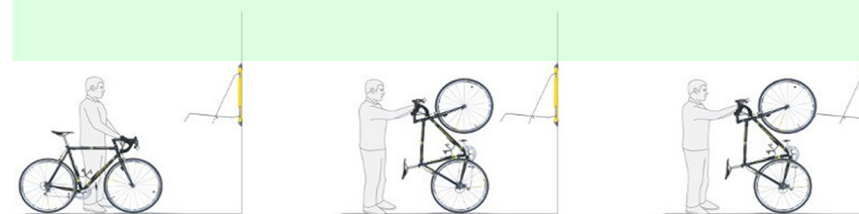

### Bike repair station

